



Available Now!
\$399,990
 From \$3,274.27*/month

14004 Sugarberry Ln
 Anaqua at Tres Lagos
 Homesite 101

Est. Completion Date: Available MAY/JUN 2026



3,077	2,452	4	2.5	2	2.0
TOTAL SQUARE FEET	LIVING SQUARE FEET	BEDROOMS	BATHS	CAR GARAGE	STORIES

Call or Text 9562758069 or visit our Sales Office Monday - Saturday 9:30 AM - 6:30 PM Sunday 12:00 PM - 6:00 PM for more info!

This beautifully designed two-story home features 4 bedrooms and 2.5 baths with a spacious, functional layout perfect for modern living. A private study offers an ideal work-from-home space, while the open-concept kitchen, living, and dining area creates a seamless setting for everyday life and entertaining. Upstairs, a versatile game room provides additional living space for relaxation or fun. Enjoy outdoor living on the covered patio, perfect for morning coffee or evening gatherings. With thoughtful design and plenty of room to grow, this home blends comfort, style, and flexibility.

Highlights:

- Upgraded Master Bay Windows in Dining
- Maple Wood Painted Cabinets
- Quartz Countertops
- GE - 5 Piece Appliance Package - Stainless Steel - Gas

The information provided in this document regarding available quick move-in homes at Esperanza Homes is intended for informational purposes only. While we strive to present accurate and up-to-date information, all details—including but not limited to pricing, availability, home features, and community amenities—are not guaranteed and are subject to change without prior notice. Dimensions and floor plans are approximate and may differ from the actual homes. Incentives and promotional offers are valid only when financing through Stonewood Home Lending and are subject to specific terms and conditions and may be limited to select homes and communities. For comprehensive terms, conditions, and further information regarding our homes and offerings, please consult with an Esperanza Homes sales consultant or visit esperanzahomes.com.



Elm

FLOOR PLAN

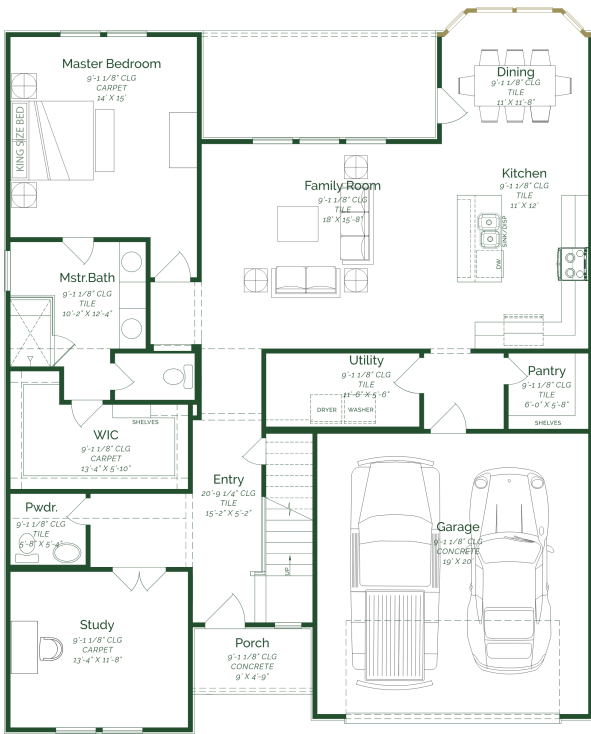

FIRST FLOOR

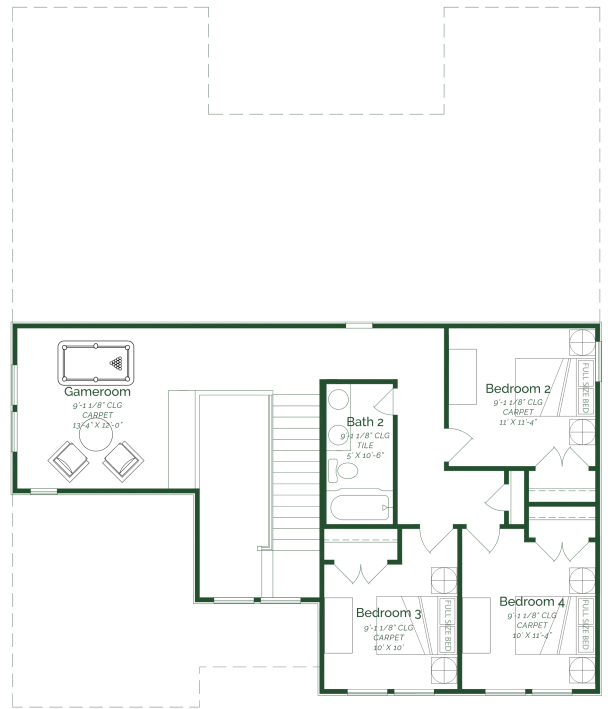

SECOND FLOOR